

MOLD SUPPLY GROUP

MOLD COMPONENTS & SUPPLIES



EPMOLD@AOL.COM
www.moldsupplygroup.com

Shoulder Pin Std. Inch.

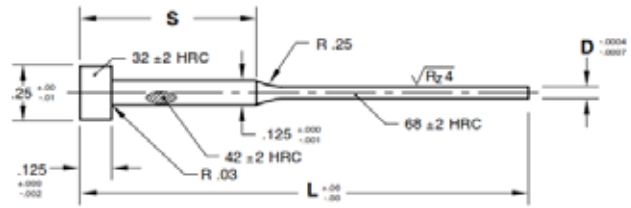

M H-13 **H** Core: 40-44 HRC, Surface: 66-70 HRC

Diameter D	Shoulder S	Regular Pin No.	Thru Hard Pin No.	L = 6"		L = 10"		L = 14"	
				STD	+ .005"	STD	+ .005"	STD	+ .005"
1/32"	2"	EP03	THP03	L06	-	L10	L105	-	-
	1/2"			L06S	-	L10S	-	-	-
3/64"	2"	EP04	THP04	L06	-	L10	L105	-	-
	1/2"			L06S	-	L10S	-	-	-
1/16"	2"	EP06	THP06	L06	-	L10	L105	L14	-
	1/2"			L06S	-	L10S	L105S	L14S	-
5/64"	2"	EP07	THP07	L06	-	L10	L10	L14	-
	1/2"			L06S	-	L10S	L10s	L14S	-
3/32"	2"	EP09	THP09	L06	-	L10	L10	L14	-
	1/2"			L06S	-	L10S	L10S	L14s	-
7/64"	2"	EP10	THP10	L06	-	L10	L10	L14	-
	1/2"			L06S	-	L10S	L10s	L14S	-

Ejector Pin Std. Inch.

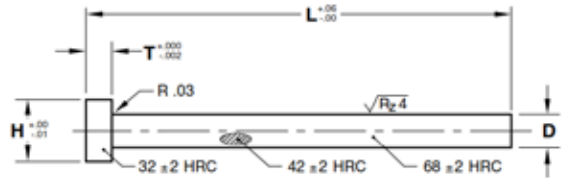

M H-13 **H** Core: 40-44 HRC, Surface: 66-70 HRC

Pin Dia. D	Catalog Regular Pin No.	Catalog True Hard Pin No.	Length										Head Dia. H	Head Thik. T
			6"		10"		14"		18"		25"			
			STD	+ .005"	STD	+ .005"	STD	+ .005"	STD	+ .005"	STD	+ .005"		
1/32	EP03	THP03	L06P	L065P	-	-	-	-	-	-	-	-	1/4	1/8
3/64	EP04	THP04	L06P	L065P	-	-	-	-	-	-	-	-	1/4	1/8
1/16	EP06	THP06	L06P	-	L10P	L10P5	-	-	-	-	-	-	1/4	1/8
5/64	EP07	THP07	L06P	-	L10P	L10P5	-	-	-	-	-	-	1/4	1/8
3/32	EP09	THP09	L06P	-	L10P	L10P5	L14P	L145	-	-	-	-	1/4	1/8
7/64	EP10	THP10	L06P	-	L10P	L10P5	-	L145	-	-	-	-	1/4	1/8
1/8	EP12	THP12	L06	-	L10	L105	L14	L145	L18	-	L25	-	1/4	1/8
9/64	EP14	THP14	-	-	L10	-	L14	L145	-	-	-	-	1/4	1/8
5/32	EP15	THP15	L06	-	L10	L105	L14	L145	L18	-	L25	-	9/32	5/32
11/64	EP17	THP17	-	-	L10	-	L14	L145	L18	-	-	-	11/32	3/16
3/16	EP18	THP18	L06	-	L10	L105	L14	L145	L18	-	L25	-	3/8	3/16
13/64	EP20	THP20	-	-	L10	-	L14	L145	L18	-	L25	-	3/8	3/16
7/32	EP21	THP21	L06	-	L10	L105	L14	L145	L18	-	L25	-	13/32	3/16
15/64	EP23	THP23	-	-	L10	-	L14	L145	L18	-	L25	-	13/32	3/16
1/4	EP25	THP25	L06	-	L10	L105	L14	L145	L18	L185	L25	-	7/16	3/16
17/64	EP26	THP26	-	-	L10	-	L14	L145	L18	-	L25	-	7/16	1/4
9/32	EP28	THP28	L06	-	L10	L105	L14	L145	L18	-	L25	-	7/16	1/4
19/64	EP29	THP29	-	-	L10	-	L14	L145	L18	-	L25	-	1/2	1/4
5/16	EP31	THP31	L06	-	L10	L105	L14	L145	L18	L185	L25	L255	1/2	1/4
21/64	EP32	THP32	-	-	L10	-	L14	L145	L18	-	L25	-	9/16	1/4
11/32	EP34	THP34	L06	-	L10	L105	L14	L145	L18	-	L25	-	9/16	1/4
23/64	EP35	THP35	-	-	L10	-	L14	L145	L18	-	L25	-	5/8	1/4
3/8	EP37	THP37	L06	-	L10	L105	L14	L145	L18	L185	L25	L255	5/8	1/4
13/32	EP40	THP40	L06	-	L10	-	L14	L145	L18	-	L25	-	11/16	1/4
7/16	EP43	THP43	L06	-	L10	L105	L14	L145	L18	-	L25	-	11/16	1/4
15/32	EP46	THP46	-	-	L10	-	L14	L145	L18	-	L25	-	3/4	1/4
1/2	EP50	THP50	L06	-	L10	L105	L14	L145	L18	-	L25	L255	3/4	1/4
17/32	EP53	THP53	-	-	L10	-	L14	L145	-	-	-	-	3/4	1/4
9/16	EP56	THP56	L06	-	L10	L105	L14	L145	L18	-	L25	-	13/16	1/4
5/8	EP62	THP62	L06	-	L10	-	L14	L145	L18	-	L25	-	7/8	1/4
11/16	EP68	THP68	-	-	L10	L105	L14	L145	L18	-	L25	-	15/16	1/4
3/4	EP75	THP75	L06	-	L10	-	L14	L145	L18	-	L25	-	1	1/4
7/8	EP87	-	-	-	L10	L105	L14	L145	L18	-	L25	-	1-1/8	1/4
1	EP100	-	L06	-	L10	-	L14	L145	L18	-	L25	-	1-1/4	1/4

Shoulder Pin Metric (mm)



M H-13 **H** Core: 40-44 HRC, Surface: 66-70 HRC

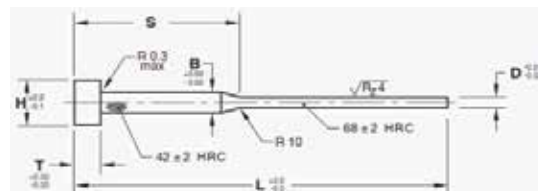

Diameter D	Diameter B	Catalog P/N	L = 80	L = 100	L = 125	L = 160	L = 160	L = 200	H	T
			S=35	S=50	S=50	S=63	S=75	S=75		
0.8	2	CN-0.8	80	100	125	160	160	200	4	2
0.9	2	CN-0.9		100	125	160	160	200	4	2
1	2	CN-1.0	80	100	125	160	160	200	4	2
1.1	2	CN-1.1		100	125	160	160	200	4	2
1.2	2	CN-1.2	80	100	125	160	160	200	4	2
1.3	2	CN-1.3	80	100	125	160	160	200	4	2
1.4	2	CN-1.4		100	125	160	160	200	4	2
1.5	3	CN-1.5	80	100	125	160	160	200	6	3
1.6	3	CN-1.6		100	125	160	160	200	6	3
1.7	3	CN-1.7		100	125	160	160	200	6	3
1.8	3	CN-1.8		100	125	160	160	200	6	3
2	3	CN-2.0		100	125	160	160	200	6	3
2.2	3	CN-2.2		100	125	160	160	200	6	3
2.5	3	CN-2.5		100	125	160	160	200	6	3

Ejector Pin Metric (mm)



H-13 Core: 40-45 RC, Surface: 66-70 HRC
M-2 Core: 58-60 RC, Surface: 66-70 HRC

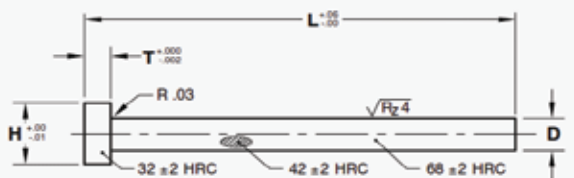

Pin Dia D	Catalog JIS H-13	Catalog HSEP M2	LENGTH														JIS Head		HSEP Head			
			100	150	200	250	300	350	400	450	500	550	600	700	800	1000	H	T	H	T		
0.6	-	HSEP.6X	HSEP	HSEP	-	-	-	-	-	-	-	-	-	-	-	-	-	-	-	3	4	
0.7	-	HSEP.7X	HSEP	HSEP	-	-	-	-	-	-	-	-	-	-	-	-	-	-	-	3	4	
0.8	-	HSEP.8X	HSEP	HSEP	-	-	-	-	-	-	-	-	-	-	-	-	-	-	-	3	4	
0.9	-	HSEP.9X	HSEP	HSEP	-	-	-	-	-	-	-	-	-	-	-	-	-	-	-	3	4	
1.0	JIS1.0X	HSEP1.0X	JIS / HSEP	JIS / HSEP	HSEP	-	-	-	-	-	-	-	-	-	-	-	-	-	3	4	3	4
1.1	JIS1.1X	HSEP1.1X	JIS / HSEP	JIS / HSEP	HSEP	-	-	-	-	-	-	-	-	-	-	-	-	-	3	4	3	4
1.2	JIS1.2X	HSEP1.2X	JIS / HSEP	JIS / HSEP	HSEP	-	-	-	-	-	-	-	-	-	-	-	-	-	3	4	3	4
1.3	JIS1.3X	HSEP1.3X	JIS / HSEP	JIS / HSEP	HSEP	-	-	-	-	-	-	-	-	-	-	-	-	-	3	4	3	4
1.4	JIS1.4X	HSEP1.4X	JIS / HSEP	JIS / HSEP	HSEP	-	-	-	-	-	-	-	-	-	-	-	-	-	3	4	3	4
1.5	JIS1.5X	HSEP1.5X	JIS / HSEP	JIS / HSEP	JIS / HSEP	-	-	-	-	-	-	-	-	-	-	-	-	-	3	4	3	4
2.0	JIS2.0X	HSEP2.0X	JIS / HSEP	JIS / HSEP	JIS / HSEP	JIS / HSEP	JIS / HSEP	JIS	JIS	-	-	-	-	-	-	-	-	-	4	4	4	4
2.3	JIS2.3X	HSEP2.3X	JIS / HSEP	JIS / HSEP	JIS	JIS	-	-	-	-	-	-	-	-	-	-	-	-	5	4	5	4
2.5	JIS2.5X	HSEP2.5X	JIS / HSEP	JIS / HSEP	JIS / HSEP	JIS / HSEP	JIS / HSEP	JIS	JIS	-	-	-	-	-	-	-	-	-	5	4	5	4
3.0	JIS3.0X	HSEP3.0X	JIS / HSEP	JIS / HSEP	JIS / HSEP	JIS / HSEP	JIS / HSEP	JIS / HSEP	JIS	JIS	JIS	-	-	-	-	-	-	-	6	4	6	4
3.5	JIS3.5X	HSEP3.5X	JIS / HSEP	JIS / HSEP	JIS / HSEP	JIS / HSEP	JIS / HSEP	JIS / HSEP	JIS	JIS	JIS	-	-	-	-	-	-	-	7	4	7	4
4.0	JIS4.0X	HSEP4.0X	JIS / HSEP	JIS / HSEP	JIS / HSEP	JIS / HSEP	JIS / HSEP	JIS / HSEP	JIS	JIS	JIS	JIS	-	-	-	-	-	-	8	6	8	4
4.5	JIS4.5X	HSEP4.5X	JIS / HSEP	JIS / HSEP	JIS / HSEP	JIS / HSEP	JIS / HSEP	JIS / HSEP	JIS	JIS	JIS	-	-	-	-	-	-	-	8	6	8	4
5.0	JIS5.0X	HSEP5.0X	JIS / HSEP	JIS / HSEP	JIS / HSEP	JIS / HSEP	JIS / HSEP	JIS / HSEP	JIS	JIS	JIS	JIS	-	-	-	-	-	-	9	6	8	4
5.5	JIS5.5X	HSEP5.5X	JIS / HSEP	JIS / HSEP	JIS / HSEP	JIS / HSEP	JIS / HSEP	JIS / HSEP	JIS	JIS	JIS	-	-	-	-	-	-	-	9	6	9	4
6.0	JIS6.0X	HSEP6.0X	JIS / HSEP	JIS / HSEP	JIS / HSEP	JIS / HSEP	JIS / HSEP	JIS / HSEP	JIS	JIS	JIS	JIS	-	-	-	-	-	-	10	6	9	4
6.5	JIS6.5X	HSEP6.5X	JIS / HSEP	JIS / HSEP	JIS / HSEP	JIS / HSEP	JIS / HSEP	JIS / HSEP	JIS	JIS	JIS	JIS	-	-	-	-	-	-	11	6	9	4
7.0	JIS7.0X	HSEP7.0X	JIS / HSEP	JIS / HSEP	JIS / HSEP	JIS / HSEP	JIS / HSEP	JIS / HSEP	JIS	JIS	JIS	JIS	-	-	-	-	-	-	11	6	9	4
7.5	-	HSEP7.5X	HSEP	HSEP	HSEP	HSEP	-	-	-	-	-	-	-	-	-	-	-	-	-	-	11	4
8.0	JIS8.0X	HSEP8.0X	JIS / HSEP	JIS / HSEP	JIS / HSEP	JIS / HSEP	JIS / HSEP	JIS / HSEP	JIS	JIS	JIS	JIS	-	-	-	-	-	-	-	-	11	4
8.5	-	HSEP8.5X	HSEP	HSEP	HSEP	HSEP	-	-	-	-	-	-	-	-	-	-	-	-	-	-	11	4
9.0	-	HSEP9.0X	HSEP	HSEP	HSEP	HSEP	HSEP	HSEP	-	-	-	-	-	-	-	-	-	-	-	-	14	4
10.0	JIS10X	HSEP10X	JIS / HSEP	JIS / HSEP	JIS / HSEP	JIS / HSEP	JIS / HSEP	JIS / HSEP	JIS	JIS	JIS	JIS	-	-	-	-	-	-	15	8	15	4
11.0	-	HSEP11X	HSEP	HSEP	HSEP	HSEP	-	-	-	-	-	-	-	-	-	-	-	-	-	-	17	4
12.0	JIS12X	HSEP12X	JIS	JIS / HSEP	JIS / HSEP	JIS / HSEP	JIS / HSEP	JIS / HSEP	JIS	JIS	JIS	JIS	-	-	-	-	-	-	17	8	17	4
14.0	MP14L	-	-	MP	MP	MP	MP	MP	MP	MP	MP	MP	MP	MP	MP	MP	MP	MP	22	7	-	-
15.0	JIS15X	-	JIS	JIS	JIS	JIS	JIS	JIS	JIS	JIS	JIS	JIS	JIS	JIS	JIS	JIS	JIS	JIS	20	8	-	-
16.0	JIS16X	-	JIS	JIS	JIS	JIS	JIS	JIS	JIS	-	JIS	JIS	JIS	JIS	JIS	JIS	JIS	JIS	21	8	-	-
18.0	MP18L	-	-	MP	MP	MP	MP	MP	MP	MP	MP	MP	MP	MP	MP	MP	MP	MP	24	7	-	-
20.0	JIS20X	-	-	JIS	JIS	-	JIS	-	JIS	-	JIS	JIS	JIS	JIS	JIS	JIS	JIS	JIS	25	8	-	-
25.0	JIS205X	-	-	-	JIS	-	JIS	-	JIS	-	JIS	JIS	JIS	JIS	JIS	JIS	JIS	JIS	30	8	-	-

EJECTOR BLADE STANDARD INCH.

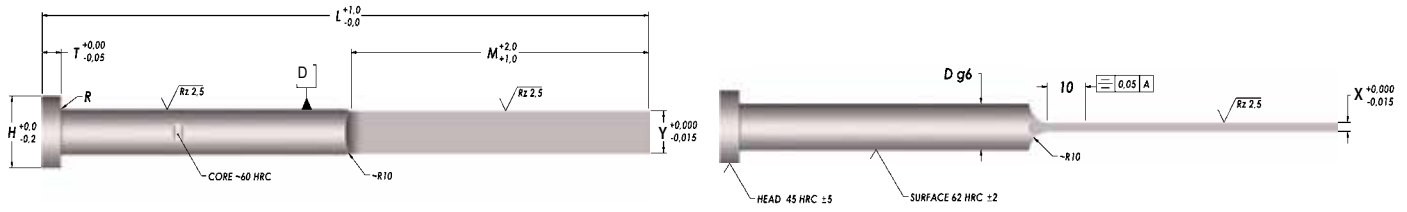

Pin Dia	Head		Blade		Lengths			Catalog Number
	Dia	Thick	Thick	Width	Shank	Blade	Overall	
D	H	T	X	Y	S	M	L	
3/32	1/4	1/8	.0320	.0780	1	5	6	EB0931006
					1-1/2	5-1/2	7	EB0931507
					2	5	7	EB0932007
					2-1/2	5-1/2	8	EB0932508
					3	5	8	EB0933008
					3-1/2	4-1/2	8	EB0933508
Radius Length = .345 Ref					4	6	10	EB0934010
3/32	1/4	1/8	.0460	.0780	1	5	6	EB0941006
					1-1/2	5-1/2	7	EB0941507
					2	5	7	EB0942007
					2-1/2	5-1/2	8	EB0942508
					3	5	8	EB0943008
					3-1/2	4-1/2	8	EB0943508
Radius Length = .305 Ref					4	6	10	EB0944010
1/8	1/4	1/8	.0200	.1000	1	5	6	EB1221006
					1-1/2	5-1/2	7	EB1221507
					2	5	7	EB1222007
					2-1/2	5-1/2	8	EB1222508
					3	5	8	EB1223008
					4	6	10	EB1224010
Radius Length = .460 Ref					5	5	10	EB1225010
1/8	1/4	1/8	.0240	.1000	1	5	6	EB1211006
					1-1/2	5-1/2	7	EB1211507
					2	5	7	EB1212007
					2-1/2	5-1/2	8	EB1212508
					3	5	8	EB1213008
					4	6	10	EB1214010
Radius Length = .444 Ref					5	5	10	EB1215010
1/8	1/4	1/8	.0320	.1000	1	5	6	EB1231006
					1-1/2	5-1/2	7	EB1231507
					2	5	7	EB1232007
					2-1/2	5-1/2	8	EB1232508
					3	5	8	EB1233008
					4	6	10	EB1234010
Radius Length = .430 Ref					5	5	10	EB1235010
1/8	1/4	1/8	.0460	.1000	1	5	6	EB1241006
					1-1/2	5-1/2	7	EB1241507
					2	5	7	EB1242007
					2-1/2	5-1/2	8	EB1242508
					3	5	8	EB1243008
					4	6	10	EB1244010
Radius Length = .395 Ref					5	5	10	EB1245010
5/32	9/32	5/32	.0200	.1400	1	5	6	EB1521006
					1-1/2	5-1/2	7	EB1521507
					2	5	7	EB1522007
					2-1/2	5-1/2	8	EB1522508
					3	5	8	EB1523008
					4	6	10	EB1524010
Radius Length = .520 Ref					5	5	10	EB1525010
5/32	9/32	5/32	.0240	.1400	1	5	6	EB1511006
					1-1/2	5-1/2	7	EB1511507
					2	5	7	EB1512007
					2-1/2	5-1/2	8	EB1512508
					3	5	8	EB1513008
					4	6	10	EB1514010
Radius Length = .508 Ref					5	5	10	EB1515010

Pin Dia	Head		Blade		Lengths			Catalog Number
	Dia	Thick	Thick	Width	Shank	Blade	Overall	
A	B	C	X	Y	S	F	L	
5/32	9/32	5/32	.0320	.1400	1	5	6	EB1531006
					1-1/2	5-1/2	7	EB1531507
					2	5	7	EB1532007
					2-1/2	5-1/2	8	EB1532508
					3	5	8	EB1533008
					4	6	10	EB1534010
Radius Length = .495 Ref					5	5	10	EB1535010
5/32	9/32	5/32	.0460	.1400	1	5	6	EB1541006
					1-1/2	5-1/2	7	EB1541507
					2	5	7	EB1542007
					2-1/2	5-1/2	8	EB1542508
					3	5	8	EB1543008
					4	6	10	EB1544010
Radius Length = .470 Ref					5	5	10	EB1545010
3/16	3/8	3/16	.0200	.1720	1	5	6	EB1821006
					1-1/2	5-1/2	7	EB1821507
					2	5	7	EB1822007
					2-1/2	5-1/2	8	EB1822508
					3	5	8	EB1823008
					4	6	10	EB1824010
Radius Length = .575 Ref					5	5	10	EB1825010
3/16	3/8	3/16	.0240	.1720	1	5	6	EB1811006
					1-1/2	5-1/2	7	EB1811507
					2	5	7	EB1812007
					2-1/2	5-1/2	8	EB1812508
					3	5	8	EB1813008
					4	6	10	EB1814010
Radius Length = .564 Ref					5	5	10	EB1815010
3/16	3/8	3/16	.0320	.1720	1	5	6	EB1831006
					1-1/2	5-1/2	7	EB1831507
					2	5	7	EB1832007
					2-1/2	5-1/2	8	EB1832508
					3	5	8	EB1833008
					4	6	10	EB1834010
Radius Length = .550 Ref					5	5	10	EB1835010
3/16	3/8	3/16	.0460	.1720	1	5	6	EB1841006
					1-1/2	5-1/2	7	EB1841507
					2	5	7	EB1842007
					2-1/2	5-1/2	8	EB1842508
					3	5	8	EB1843008
					4	6	10	EB1844010
Radius Length = .525 Ref					5	5	10	EB1845010
3/16	3/8	3/16	.0620	.1720	1	5	6	EB1861006
					1-1/2	5-1/2	7	EB1861507
					2	5	7	EB1862007
					2-1/2	5-1/2	8	EB1862508
					3	5	8	EB1863008
					4	6	10	EB1864010
Radius Length = .495 Ref					5	5	10	EB1865010
7/32	13/32	3/16	.0200	.2000	1	5	6	EB2121006
					1-1/2	5-1/2	7	EB2121507
					2	5	7	EB2122007
					2-1/2	5-1/2	8	EB2122508
					3	5	8	EB2123008
					4	6	10	EB2124010
Radius Length = .625 Ref					5	5	10	EB2125010

Pin Dia	Head		Blade		Lengths			Catalog Number
	Dia	Thick	Thick	Width	Shank	Blade	Overall	
A	B	C	T	W	S	F	L	
9/32	7/16	1/4	.0460	.2640	1	5	6	EB2841006
					1-1/2	5-1/2	7	EB2841507
					2	5	7	EB2842007
					2-1/2	5-1/2	8	EB2842508
					3	5	8	EB2843008
					4	6	10	EB2844010
Radius Length = .675 Ref					5	5	10	EB2845010
9/32	7/16	1/4	.0620	.2640	1	5	6	EB2861006
					1-1/2	5-1/2	7	EB2861507
					2	5	7	EB2862007
					2-1/2	5-1/2	8	EB2862508
					3	5	8	EB2863008
					4	6	10	EB2864010
Radius Length = .655 Ref					5	5	10	EB2865010
5/16	1/2	1/4	.0320	.2970	1	5	6	EB3131006
					1-1/2	5-1/2	7	EB3131507
					2	5	7	EB3132007
					2-1/2	5-1/2	8	EB3132508
					3	5	8	EB3133008
					4	6	10	EB3134010
Radius Length = .740 Ref					5	5	10	EB3135010
5/16	1/2	1/4	.0460	.2970	1	5	6	EB3141006
					1-1/2	5-1/2	7	EB3141507
					2	5	7	EB3142007
					2-1/2	5-1/2	8	EB3142508
					3	5	8	EB3143008
					4	6	10	EB3144010
Radius Length = .720 Ref					5	5	10	EB3145010
5/16	1/2	1/4	.0620	.2970	1	5	6	EB3161006
					1-1/2	5-1/2	7	EB3161507
					2	5	7	EB3162007
					2-1/2	5-1/2	8	EB3162508
					3	5	8	EB3163008
					4	6	10	EB3164010
Radius Length = .700 Ref					5	5	10	EB3165010
5/16	1/2	1/4	.0780	.2970	1	5	6	EB3171006
					1-1/2	5-1/2	7	EB3171507
					2	5	7	EB3172007
					2-1/2	5-1/2	8	EB3172508
					3	5	8	EB3173008
					4	6	10	EB3174010
Radius Length = .675 Ref					5	5	10	EB3175010
3/8	5/8	1/4	.0320	.3590	1	5	6	EB3731006
					1-1/2	5-1/2	7	EB3731507
					2	5	7	EB3732007
					2-1/2	5-1/2	8	EB3732508
					3	5	8	EB3733008
					4	6	10	EB3734010
Radius Length = .810 Ref					5	5	10	EB3735010
3/8	5/8	1/4	.0460	.3590	1	5	6	EB3741006
					1-1/2	5-1/2	7	EB3741507
					2	5	7	EB3742007
					2-1/2	5-1/2	8	EB3742508
					3	5	8	EB3743008
					4	6	10	EB3744010
Radius Length = .800 Ref					5	5	10	EB3745010
3/8	5/8	1/4	.0620	.3590	1	5	6	EB3761006
					1-1/2	5-1/2	7	EB3761507
					2	5	7	EB3762007
					2-1/2	5-1/2	8	EB3762508
					3	5	8	EB3763008
					4	6	10	EB3764010
Radius Length = .780 Ref					5	5	10	EB3765010

*1/16 & 5/64 Pin Available

*7/16 & 1/2 Pin Available

Core Pins Soft & Hard

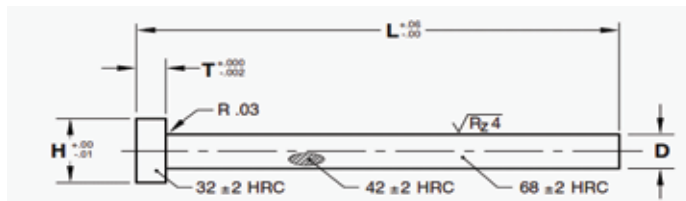

Thru Hard Core Pin:

Soft Core Pin:

M H-13 **H** Core: 40-44 HRC, Surface: 66-70 HRC

M H-13

H Core: 30-35 HRC, Surface: 66-70 HRC

Pin Dia. D	Catalog Soft Pin No.	Catalog Hard Pin No.	Length				Head Dia H	Head Thik T
			3"	6"	10"	14"		
3/32	CPS09	CPH09	L03	L06	L10		1/4	1/8
7/64	CPS10	CPH10	L03	L06	L10		1/4	1/8
1/8	CPS12	CPH12	L03	L06	L10	L14	1/4	1/8
9/64	CPS14	CPH14	L03	L06	L10	L14	1/4	1/8
5/32	CPS15	CPH15	L03	L06	L10	L14	9/32	5/32
11/64	CPS17	CPH17	L03	L06	L10	L14	11/32	3/16
3/16	CPS18	CPH18	L03	L06	L10	L14	3/8	3/16
13/64	CPS20	CPH20	L03	L06	L10	L14	3/8	3/16
7/32	CPS21	CPH21	L03	L06	L10	L14	13/32	3/16
1/4	CPS25	CPH25	L03	L06	L10	L14	7/16	3/16
9/32	CPS28	CPH28	L03	L06	L10	L14	7/16	1/4
5/16	CPS31	CPH31	L03	L06	L10	L14	1/2	1/4
11/32	CPS34	CPH34	L03	L06	L10	L14	9/16	1/4
3/8	CPS37	CPH37	L03	L06	L10	L14	5/8	1/4
13/32	CPS40	CPH40	L03	L06	L10	L14	11/16	1/4
7/16	CPS43	CPH43	L03	L06	L10	L14	11/16	1/4
15/32	CPS46	CPH46	L03	L06	L10	L14	3/4	1/4
1/2	CPS50	CPH50	L03	L06	L10	L14	3/4	1/4
9/16	CPS56	CPH56	-	L06	L10	L14	13/16	1/4
5/8	CPS62	CPH62	-	L06	L10	L14	7/8	1/4
3/4	CPS75	CPH75	-	L06	L10	L14	1	1/4
7/8	CPS87	CPH87	-	L06	L10	L14	1-1/8	1/4
1	CPS100	CPH100	-	L06	L10	L14	1-1/4	1/4

Mold Max Core Pins

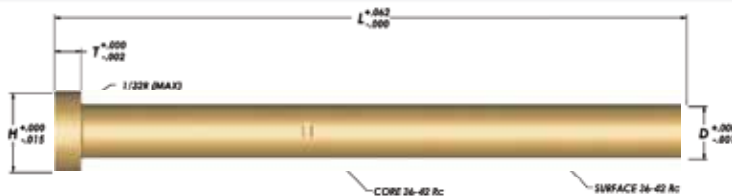

Diameter D	Catalog P/N	L = length				H	T
		4"	8"	12"	18"		
1/8	MM12	L04	L08	L12		1/4	1/8
5/32	MM15	L04	L08	L12	L18	9/32	5/32
3/16	MM18	L04	L08	L12	L18	3/8	3/16
7/32	MM21	L04	L08	L12	L18	13/32	3/16
1/4	MM25	L04	L08	L12	L18	7/16	3/16
9/32	MM28	L04	L08	L12	L18	7/16	1/4
5/16	MM31	L04	L08	L12	L18	1/2	1/4
3/8	MM37	L04	L08	L12	L18	5/8	1/4
7/16	MM43	L04	L08	L12	L18	11/16	1/4
1/2	MM50	L04	L08	L12	L18	3/4	1/4
9/16	MM56	L04	L08	L12	L18	13/16	1/4
5/8	MM62	L04	L08	L12	L18	7/8	1/4
3/4	MM75	L04	L08	L12	L18	1	1/4

Sleeve Standard (inch)

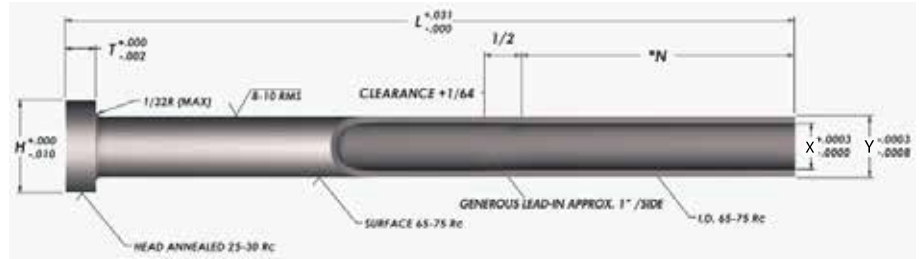

M H-13 **H** Core: 40-44 HRC, Surface: 66-70 HRC

X I.D.	Y O.D.	Catalog No.	Length												N	H	T
			3"	4"	5"	6"	7"	8"	9"	10"	11"	12"	13"	14"			
3/32	3/16	SE02	L03	L04	L05	L06	L07	L08	-	-	-	-	-	-	1-3/4"	3/16	3/16
1/8	7/32	SE03	L03	L04	L05	L06	L07	L08	L09	L10	L11	L12	L13	L14	1-3/4"	13/32	3/16
5/32	1/4	SE04	-	L04	L05	L06	L07	L08	L09	L10	L11	L12	L13	L14	2-1/4"	7/16	3/16
3/16	5/16	SE05	-	L04	L05	L06	L07	L08	L09	L10	L11	L12	L13	L14	2-1/4"	1/2	1/4
7/32	11/32	SE55	-	L04	L05	L06	L07	L08	L09	L10	L11	L12	L13	L14	2-1/4"	9/16	1/4
1/4	3/8	SE06	-	L04	L05	L06	L07	L08	L09	L10	L11	L12	L13	L14	2-1/4"	5/8	1/4
5/16	7/16	SE07	-	L04	L05	L06	L07	L08	L09	L10	L11	L12	L13	L14	2-1/4"	11/16	1/4
3/8	1/2	SE08	-	L04	L05	L06	L07	L08	L09	L10	L11	L12	L13	L14	2-1/4"	3/4	1/4
7/16	5/8	SE09	-	L04	L05	L06	L07	L08	L09	L10	L11	L12	L13	L14	2-1/4"	7/8	1/4
1/2	11/16	SE10	-	L04	L05	L06	L07	L08	L09	L10	L11	L12	L13	L14	2-1/4"	15/16	1/4
9/16	3/4	SE11	-	L04	L05	L06	L07	L08	L09	L10	L11	L12	L13	L14	2-1/4"	1"	1/4
5/8	7/8	SE12	-	L04	L05	L06	L07	L08	L09	L10	L11	L12	L13	L14	2-1/4"	1-1/8"	1/4
3/4	1	SE13	-	L04	L05	L06	L07	L08	L09	L10	L11	L12	L13	L14	2-1/4"	1-1/4"	1/4

Sleeve Metric (mm)

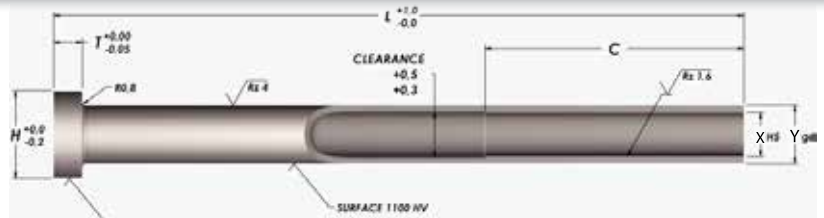

M H-13 **H** Core: 40-44 HRC, Surface: 66-70 HRC

X I.D.	Y O.D.	Catalog No.	Length									C	H	T
			75	100	125	150	175	200	225	250	275 THP			
4.0	2.0	SN-04.0X02.0	75	100	125	150	-	-	-	-	-	35	8.0	3.0
	2.2	SN-04.0X02.2	75	100	125	150	-	-	-	-	-			
5.0	2.5	SN-05.0X02.5	75	100	125	150	-	-	-	-	-	35	10.0	3.0
	2.7	SN-05.0X02.7	75	100	125	150	-	-	-	-	-			
	3.0	SN-05.0X03.0	75	100	125	150	175	-	-	-	275			
	3.2	SN-05.0X03.2	75	100	125	150	175	-	-	-	275			
6.0	3.0	SN-06.0X03.0	75	100	125	-	-	-	-	-	275	45	12.0	5.0
	3.5	SN-06.0X03.5	75	100	125	150	175	-	-	-	275			
	3.7	SN-06.0X03.7	75	100	125	150	-	-	-	-	275			
	4.0	SN-06.0X04.0	75	100	125	150	175	200	-	-	275			
8.0	4.2	SN-08.0X04.2	75	100	125	150	175	-	-	-	275	50	12.0	5.0
	4.0	SN-08.0X04.0	75	100	125	150	-	-	-	-	275			
	4.2	SN-08.0X04.2	75	100	125	150	175	200	-	-	275			
	5.0	SN-08.0X05.0	75	100	125	150	175	200	225	-	275			
10.0	5.2	SN-08.0X05.2	75	100	125	150	175	200	225	-	275	50	16.0	5.0
	6.0	SN-10.0X06.0	75	100	125	150	175	200	225	-	275			
12.0	6.2	SN-10.0X06.2	75	100	125	150	175	200	225	-	275	50	20.0	7.0
	8.0	SN-12.0X08.0	75	100	125	150	175	200	225	250	275			
14.0	8.2	SN-12.0X08.2	75	100	125	150	175	200	225	250	275	50	22.0	7.0
	10.0	SN-14.0X10.0	-	100	125	150	175	200	225	250	275			
16.0	10.2	SN-14.0X10.2	-	100	125	150	175	200	225	250	275	50	22.0	7.0
	12.0	SN-16.0X12.0	-	100	125	150	175	200	225	250	275			

Ejector Blade Metric

Nominal Size	g6		
Over	To	Tolerance (mm)	
3mm	6mm	-.004	-.012
6mm	10mm	-.005	-.014
10mm	18mm	-.006	-.017

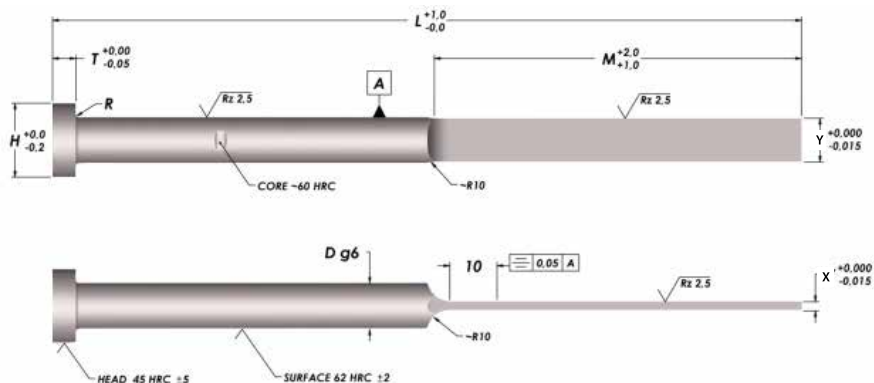

M H-13 **H** Core: 40-44 HRC, Surface: 66-70 HRC

Blade With Y	Blade Thik X	Catalog Blade No.	Length									Pind Dia. D	Head Dia. H	Head Thik T
			63 M=32	80 M=40	100 M=50	125 M=63	160 M=80	200 M=100	250 M=125	315 M=160	400 M=200			
3.5	0.8	B03508	63	80	100	125	160	-	-	-	-	4.0	8.0	3.0
	1.0	B03510	63	80	100	125	160	200	250	-	-			
	1.2	B03512	-	80	100	125	160	200	-	-	-			
3.8	0.8	B03808	63	80	100	125	160	-	-	-	-	4.2	8.0	3.0
	1.0	B03810	63	80	100	125	160	-	-	-	-			
	1.2	B03812	-	80	100	125	160	200	-	-	-			
4.5	1.0	B04510	63	80	100	125	160	200	-	-	-	5	10.0	3
	1.2	B04512	-	80	100	125	160	200	-	-	-			
	1.5	B04515	-	80	100	125	160	200	-	-	-			
5.5	1.0	B05510	-	80	100	125	160	200	-	-	-	6.0	12.0	5.0
	1.2	B05512	-	80	100	125	160	200	250	-	-			
	1.5	B05515	-	80	100	125	160	200	250	-	-			
	2.0	B05520	-	80	100	125	160	200	250	-	-			
7.5	1.0	B07510	-	-	-	125	160	-	-	-	-	8.0	14.0	5.0
	1.2	B07512	-	-	100	125	160	200	250	-	-			
	1.5	B07515	-	-	100	125	160	200	250	315	-			
	2.0	B07520	-	-	100	125	160	200	250	315	-			
9.5	1.2	B09512	-	-	-	-	160	200	-	-	-	10.0	16.0	5.0
	1.5	B09515	-	-	-	-	160	200	250	315	400			
	2.0	B09520	-	-	-	-	160	200	250	315	400			
11.5	2.0	B11520	-	-	-	-	-	200	250	315	400	12.0	18.0	7.0
	2.5	B11525	-	-	-	-	-	200	250	315	400			
15.5	2.0	B15520	-	-	-	-	-	200	250	315	400	16.0	22.0	7.0
	2.5	B15525	-	-	-	-	-	200	250	315	400			

Angle Pin Radius



M H-13 **H** Core: 40-44 HRC, Surface: 66-70 HRC

Pin Dia No.	Catalog No	Pin	Length			Head Dia. H	Head Thik T	PFL 6" +.00 -.06	PFL 10" & 14" +.00 -.06	D2 +.0000 - .0005	RAD SPH R
			6"	10"	14"						
3/8	AP37	L06	L10	-	-	1/2	1/4	7/8	1-3/8"	0.3765	3/8
1/2	AP50	L06	L10	-	-	5/8	1/4	7/8	1-3/8"	0.5015	1/2
5/8	AP62	L06	L10	-	-	3/4	1/4	7/8	1-3/8"	0.6265	5/8
3/4	AP75	-	L10	L14	-	7/8	5/16	-	1-3/8"	0.7515	3/4
1	AP100	-	L10	L14	-	1-1/4"	5/16	-	1-3/8"	1.0015	1

Leader Pin

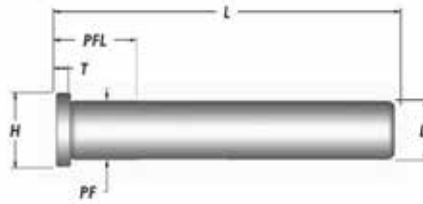

Nominal Diameter	D +0.000 -0.005	PF +0.005 -0.006	H +0.005 -0.007	T +0.005 -0.008
3/4	0.749	0.751	0.99	3/16
7/8	0.874	0.876	1.115	1/4
1	0.999	1.001	1.24	1/4
1 1/4	1.249	1.251	1.49	5/16
1 1/2	1.499	1.501	1.74	5/16
2	1.999	2.001	2.24	5/16
2 1/2	2.499	2.501	2.74	5/16
3	2.999	3.001	3.365	1/2

Length L	D=3/4		D=7/8		D=1		D=1 - 1/4		D=1 - 1/2		D=2		D=2 - 1/2		D=3		
	PFL	Cat No.	PFL	Cat No.	PFL	Cat No.	PFL	Cat No.	PFL	Cat No.	PFL	Cat No.	PFL	Cat No.	PFL	Cat No.	
1-3/4"	7/8	1000	7/8	1099	7/8	1198	-	-	-	-	-	-	-	-	-	-	
2-1/4"	7/8	1001	7/8	1100	7/8	1199	-	-	-	-	-	-	-	-	-	-	
2-3/4"	7/8	1002	7/8	1101	7/8	1200	7/8	1300	1-3/8"	1402	-	-	-	-	-	-	
3-1/4"	7/8	1003	7/8	1102	7/8	1201	7/8	1301	1-3/8"	1403	-	-	-	-	-	-	
3-3/4"	7/8	1004	7/8	1103	7/8	1202	7/8	1302	1-3/8"	1404	-	-	-	-	-	-	
4-1/4"	1-3/8"	1005	1-3/8"	1104	1-3/8"	1203	7/8	1303	1-3/8"	1405	-	-	-	-	-	-	
4-3/4"	1-3/8"	1006	1-3/8"	1105	1-3/8"	1204	1-3/8"	1304	1-3/8"	1406	1-7/8"	1606	2-3/8"	1806	-	-	
5-1/4"	1-3/8"	1007	1-3/8"	1106	1-3/8"	1205	1-3/8"	1305	1-3/8"	1407	-	-	-	-	-	-	
5-3/4"	1-7/8"	1008	1-3/8"	1107	1-3/8"	1206	1-3/8"	1306	1-3/8"	1408	1-7/8"	1608	2-3/8"	1808	-	-	
6-1/4"	1-7/8"	1009	1-7/8"	1108	1-3/8"	1207	1-3/8"	1307	-	-	-	-	-	-	-	-	
6-3/4"	1-7/8"	1010	1-7/8"	1109	1-7/8"	1208	1-7/8"	1308	1-7/8"	1410	1-7/8"	1610	2-3/8"	1810	-	-	
7-1/4"	1-7/8"	1011	1-7/8"	1110	1-7/8"	1209	1-7/8"	1309	-	-	-	-	-	-	-	-	
7-3/4"	1-7/8"	1012	1-7/8"	1111	1-7/8"	1210	1-7/8"	1310	1-7/8"	1412	1-7/8"	1612	2-3/8"	1812	-	-	
8-1/4"	-	-	1-7/8"	1112	1-7/8"	1211	1-7/8"	1311	-	-	-	-	-	-	-	-	
8-3/4"	-	-	1-7/8"	1113	1-7/8"	1212	1-7/8"	1312	1-7/8"	1414	1-7/8"	1614	2-3/8"	1814	-	-	
9-1/4"	1-7/8"	1015	-	-	1-7/8"	1213	1-7/8"	1313	-	-	-	-	-	-	-	-	
9-3/4"	-	-	-	-	1-7/8"	1214	1-7/8"	1314	1-7/8"	1416	1-7/8"	1616	2-3/8"	1816	-	-	
10-1/4"	-	-	-	-	1-7/8"	1215	1-7/8"	1315	-	-	-	-	-	-	-	-	
10-3/4"	-	-	1-7/8"	1117	1-7/8"	1216	1-7/8"	1316	1-7/8"	1418	1-7/8"	1618	2-3/8"	1818	-	-	
11-1/4"	-	-	-	-	1-7/8"	1217	1-7/8"	1317	-	-	-	-	-	-	-	-	
11-3/4"	-	-	-	-	1-7/8"	1218	1-7/8"	1318	1-7/8"	1420	1-7/8"	1620	2-3/8"	1820	2-7/8"	3020	
12-1/4"	-	-	1-7/8"	1120	1-7/8"	1219	1-7/8"	1319	1-7/8"	1422	1-7/8"	1622	2-3/8"	1822	-	-	
12-3/4"	-	-	-	-	-	-	1-7/8"	1320	1-7/8"	1424	1-7/8"	1624	2-3/8"	1824	2-7/8"	3024	
13-3/4"	-	-	-	-	-	-	1-7/8"	1322	1-7/8"	1426	1-7/8"	1626	2-3/8"	1826	-	-	
14-3/4"	-	-	-	-	-	-	1-7/8"	1324	-	-	-	2-3/8"	1628	2-3/8"	1828	2-7/8"	3028
15-3/4"	-	-	-	-	-	-	-	1326	-	-	-	2-3/8"	1632	2-3/8"	1832	2-7/8"	3032

Shoulder Bushing

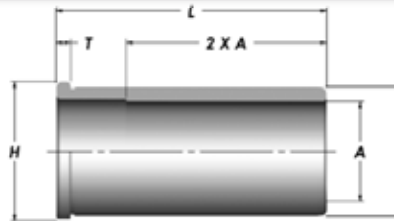

Nominal I.D.	A +0.000 -0.000	B +0.005 -0.000	H +0.005 -0.005	T +0.000 -0.005
3/4	0.7505	1.1255	1.302	3/16
7/8	0.8755	1.2505	1.375	3/16
1	1.0005	1.3755	1.500	3/16
1.25	1.2505	1.6255	1.750	3/16
1.5	1.5005	2.0005	2.125	3/16
2	2.0005	2.5005	2.625	3/16
2.5	2.5005	3.2505	3.375	3/16
3	3.0005	3.7505	3.937	1/2

Length L	CATALOG NUMBER											
	A=3/4"			A=7/8"			A=1"			A=1 - 1/4"		
	Steel	Self Lub	Bronze	Steel	Self Lub	Bronze	Steel	Self Lub	Bronze	Steel	Self Lub	Bronze
7/8	2700	2700SL	2700SB	2710	2710SL	2710SB	2730	2730SL	2730SB	2750	2750SL	2750SB
1-3/8"	2701	2701SL	2701SB	2711	2711SL	2711SB	2731	2731SL	2731SB	2751	2751SL	2751SB
1-7/8"	2702	2702SL	2702SB	2712	2712SL	2712SB	2732	2732SL	2732SB	2752	2752SL	2752SB
2-3/8"	2703	2703SL	2703SB	2713	2713SL	2713SB	2733	2733SL	2733SB	2753	2753SL	2753SB
2-7/8"	2704	2704SL	2704SB	2714	2714SL	2714SB	2734	2734SL	2734SB	2754	2754SL	2754SB
3-3/8"	2705	2705SL	2705SB	2715	2715SL	2715SB	2735	2735SL	2735SB	2755	2755SL	2755SB
3-7/8"	2706	2706SL	2706SB	2716	2716SL	2716SB	2736	2736SL	2736SB	2756	2756SL	2756SB
4-3/8"	2707	2707SL	2707SB	2717	2717SL	-	2737	2737SL	2737SB	2757	2757SL	2757SB
4-7/8"	2708	2708SL	-	2718	2718SL	-	2738	2738SL	2738SB	2758	2758SL	2758SB
5-7/8"	2709	2709SL	-	2720	2720SL	-	2740	2740SL	2740SB	2760	2760SL	2760SB

Length L	CATALOG NUMBER											
	A=1 - 1/2"			A=2"			A=2 - 1/2"			A=3"		
	Steel	Self Lub	Bronze	Steel	Self Lub	Bronze	Steel	Self Lub	Bronze	Steel	Self Lub	Bronze
7/8	2770	2770	2770	-	-	-	-	-	-	-	-	-
1-3/8"	2771	2771	2771	2901	2901SL	2901SB	2951	2951SL	-	-	-	-
1-7/8"	2772	2772	2772	2902	2902SL	2902SB	2952	2952SL	-	-	-	-
2-3/8"	2773	2773	2773	2903	2903SL	2903SB	2953	2953SL	-	-	-	-
2-7/8"	2774	2774	2774	2904	2904SL	2904SB	2954	2954SL	-	-	-	-
3-3/8"	2775	2775	2775	2905	2905SL	2905SB	2955	2955SL	-	-	-	-
3-7/8"	2776	2776	2776	2906	2906SL	2906SB	2956	2956SL	-	3976	3976SL	-
4-3/8"	2777	2777	2777	2907	2907SL	2907SB	2957	2957SL	-	-	-	-
4-7/8"	2778	2778	2778	2908	2908SL	2908SB	2958	2958SL	-	3978	3978SL	-
5-7/8"	2780	2780	2780	2910	2910SL	2910SB	2960	2960SL	-	3980	3980SL	-
7-7/8"	-	-	-	-	-	-	-	-	-	3984	3984SL	-

Springs



Hole Dia. O.D.	Rod Dia. I.D.	Free Length	BLUE	RED	GOLD
			Cat. Number Medium Duty	Cat. Number Heavy Duty	Cat. Number Extra H. Duty
3/8"	3/16"	1"	04M10A	04MH10A	04H10A
		1 1/4"	04M12A	04MH12A	04H12A
		1 1/2"	04M15A	04MH15A	04H15A
		1 3/4"	04M17A	04MH17A	04H17A
		2"	04M20A	04MH20A	04H20A
		2 1/2"	04M25A	04MH25A	04H25A
		3"	04M30A	04MH30A	04H30A
		12"	04M120A	04MH120A	04H120A
1/2"	9/32"	1"	05M10A	05MH10A	05H10A
		1 1/4"	05M12A	05MH12A	05H12A
		1 1/2"	05M15A	05MH15A	05H15A
		1 3/4"	05M17A	05MH17A	05H17A
		2"	05M20A	05MH20A	05H20A
		2 1/2"	05M25A	05MH25A	05H25A
		3"	05M30A	05MH30A	05H30A
		3 1/2"	05M35A	05MH35A	05H35A
		4 1/2"	05M45A	-	-
		5 1/2"	05M55A	-	-
		6 1/2"	05M65A	-	-
		7 1/2"	05M75A	-	-
5/8"	11/32"	1"	06M10A	06MH10A	06H10A
		1-1/4"	06M12A	06MH12A	06H12A
		1-1/2"	06M15A	06MH15A	06H15A
		1-3/4"	06M17A	06MH17A	06H17A
		2"	06M20A	06MH20A	06H20A
		2-1/2"	06M25A	06MH25A	06H25A
		3"	06M30A	06MH30A	06H30A
		3-1/2"	06M35A	06MH35A	06H35A
		4"	06M40A	06MH40A	06H40A
		12"	06M120A	06MH120A	06H120A
3/4"	3/8"	1"	07M10A	07MH10A	07H10A
		1 1/4"	07M12A	07MH12A	07H12A
		1 1/2"	07M15A	07MH15A	07H15A
		1 3/4"	07M17A	07MH17A	07H17A
		2"	07M20A	07MH20A	07H20A
		2 1/2"	07M25A	07MH25A	07H25A
		3"	07M30A	07MH30A	07H30A
		3 1/2"	07M35A	07MH35A	07H35A
		4"	07M40A	07MH40A	07H40A
		4 1/2"	07M45A	07MH45A	07H45A
		5"	07M50A	07MH50A	-
		5 1/2"	07M55A	07MH55A	-
		6"	07M60A	07MH60A	-
		6 1/2"	07M65A	-	-
		7 1/2"	07M75A	-	-
		12"	07M120A	07MH120A	07H120A

Hole Dia. O.D.	Rod Dia. I.D.	Free Length	BLUE	RED	GOLD
			Cat. Number Medium Duty	Cat. Number Heavy Duty	Cat. Number Extra H. Duty
1"	1/2"	1"	10M10A	10MH10A	10H10A
		1 1/4"	10M12A	10MH12A	-
		1 1/2"	10M15A	10MH15A	10H15A
		1 3/4"	10M17A	10MH17A	10H17A
		2"	10M20A	10MH20A	10H20A
		2 1/2"	10M25A	10MH25A	10H25A
		3"	10M30A	10MH30A	10H30A
		3 1/2"	10M35A	10MH35A	10H35A
		4"	10M40A	10MH40A	10H40A
		4 1/2"	10M45A	10MH45A	10H45A
		5"	10M50A	10MH50A	10H50A
		5 1/2"	10M55A	10MH55A	-
		6"	10M60A	10MH60A	10MH60A
		7"	10M70A	10MH70A	-
1-1/4"	5/8"	1 1/2"	12M15A	12MH15A	12H15A
		1 3/4"	12M17A	12MH17A	12H17A
		2"	12M20A	12MH20A	12H20A
		2 1/2"	12M25A	12MH25A	12H25A
		3"	12M30A	12MH30A	12H30A
		3 1/2"	12M35A	12MH35A	12H35A
		4"	12M40A	12MH40A	12H40A
		4 1/2"	12M45A	12MH45A	12H45A
		5"	12M50A	12MH50A	12H50A
		5 1/2"	12M55A	12MH55A	12H55A
		6"	12M60A	12MH60A	12H60A
		7"	12M70A	12MH70A	12H70A
		8"	12M80A	12MH80A	12H80A
		10"	12M10A	12MH10A	12H10A
1-1/2"	3/4"	2"	15M20A	15MH20A	15H20A
		2-1/2"	15M25A	15MH25A	15H25A
		3"	15M30A	15MH30A	15H30A
		3-1/2"	15M35A	15MH35A	15H35A
		4"	15M40A	15MH40A	15H40A
		4-1/2"	15M45A	15MH45A	15H45A
		5"	15M50A	15MH50A	15H50A
		5-1/2"	15M55A	15MH55A	15H55A
		6"	15M60A	15MH60A	15H60A
		7"	15M70A	15MH70A	15H70A
		8"	15M80A	15MH80A	15H80A
		10"	15M10A	15MH10A	15H10A
		12"	15M120A	15MH120A	15H120A
		2"	1"	2-1/2"	20M25A
3"	20M30A			20MH30A	20H30A
3-1/2"	20M35A			20MH35A	20H35A
4"	20M40A			20MH40A	20H40A
4-1/2"	20M45A			20MH45A	20H45A
5"	20M50A			20MH50A	20H50A
5-1/2"	20M55A			20MH55A	20H55A
6"	20M60A			20MH60A	20H60A
7"	20M70A			20MH70A	20H70A
8"	20M80A			20MH80A	20H80A
10"	20M10A			20MH10A	20H10A
12"	20M120A			20MH120A	20H120A

Front Removable Date Stamps

Series "E"

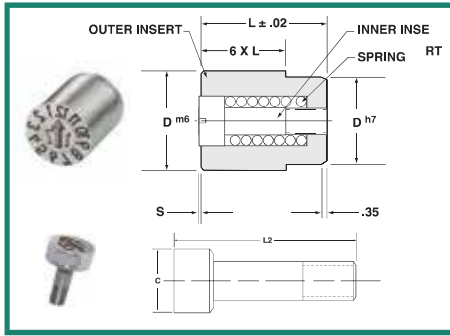

INSERT ASSEMBLIES

D	L	12 Months w/arrow	12 Months w arrow/year*	Years/ arrow**	Days/ arrow	Shifts/ arrow	Blank/ arrow
4	8	MO408	MO4 x __	A04 x __	DA04	SH04	BLO408
5	8	MO508	MO5 x __	A05 x __	DA05	SH05	BL0508
6	8	MO608	MO6 x __	A06 x __	DA06	SH06	BL0608
8	10	MO810	MO8 x __	A08 x __	DA08	SH08	BL0810
10	12	MO1012	M10 x __	A10 x __	DA10	SH10	BL1012
12	14	MO1214	M12 x __	A12 x __	DA12	SH12	BL1214
16	14	MO1614	M16 x __	A16 x __	DA16	SH16	BL1614
20	16	MO2016	M20 x __	A20 x __	DA20	SH20	BL2016

Replacement Inserts & Bodies

DIMENSIONAL DATA

D(mm) Dia.	E (mm)	L(mm) Length	S(mm) Etch Depth	Tolerance(mm)	
				m6	h7
4	2.1	8	.203	+0.012 to +.004	0 to -.012
5	3.1	8	.203	+0.012 to +.004	0 to -.012
6	3.1	8	.203	+0.012 to +.004	0 to -.012
8	4.4	10	.254	+0.015 to +.006	0 to -.015
10	5.2	12	.3556	+0.015 to +.006	0 to -.015
12	6.2	14	.3556	+0.018 to +.007	0 to -.018
16	8.2	14	.3556	+0.018 to +.007	0 to -.018
20	11	16	.3556	+0.021 to +.008	0 to -.021

REPLACEMENT BODIES

D	L	12 Months	Years*	Days	Shifts	Blank
4	8	MBO4	AB04	DB04	SB04	BLB04
5	8	MBO5	AB05	DB05	SB05	BLB05
6	8	MBO6	AB06	DB06	SB06	BLB06
8	10	MBO8	AB08	DB08	SB08	BLB08
10	12	MB10	AB10	DB10	SB10	BLB10
12	14	MB12	AB12	DB12	SB12	BLB12
16	14	MB16	AB16	DB16	SB16	BLB16
20	16	MB20	AB20	DB20	SB20	BLB20

REPLACEMENT INSERTS (with springs)

Arrow Only	Arrow & Year*	C	L2
AR04	AY04	2.1	8
AR05	AY05	3.1	8
AR06	AY06	3.1	8
AR08	AY08	4.4	10
AR10	AY10	5.2	12
AR12	AY12	6.2	14
AR16	AY16	8.2	14
AR20	AY20	11	16

REPLACEMENT SPRINGS (pkg of 5)

D(mm) Diameter	Cat. Number
4	RS04
5	RS05
6	RS06
8	RS08
10	RS10
12	RS12
16	RS16
20	RS20

Front Removable Date Stamps CUMSA

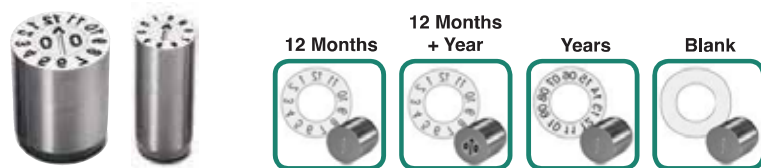

12 Months	12 Mon. + Yr. ¹	Years ¹	Blank	31 Days	Shifts	A	C	D	E	L	N ²
FA.0422SF	FA.042212-__	FA.042204-__	FA.042200		FA.0422SP	4	2.2	6	3.5	12	4
FA.0530SF	FA.053012-__	FA.053004-__	FA.053000		FA.0530SP	5	3	6	3.5	12	4
FA.0632SF	FA.063212-__	FA.063205-__	FA.063200	FA.0632-31	FA.0632SP	6	3.2	12	4	20	5
FA.0847SF	FA.084712-__	FA.084705-__	FA.084700	FA.0847-31	FA.0847SP	8	4.7	12	6	20	5
FA.1057SF	FA.105712-__	FA.105706-__	FA.105700	FA.1057-31	FA.1057SP	10	5.7	12	8	20	6
FA.1267SF	FA.126712-__	FA.126708-__	FA.126700	FA.1267-31	FA.1267SP	12	6.7	12	10	20	8
FA.1687SF	FA.168712-__	FA.168710-__	FA.168700	FA.1687-31	FA.1687SP	16	8.7	12	12	20	10
FA.2007SF	FA.200712-__	FA.200710-__	FA.200700	FA.2007-31	FA.2007SP	20	10.7	12	14	20	10

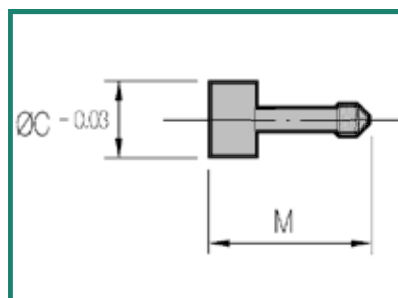
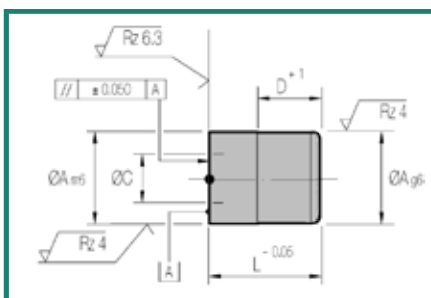

Arrow only	Arrow & Year ¹	C	M
IA.2275SF	IA.2275__	2.2	7.7
IA.3075SF	IA.3075__	3	7.7
IA.3217SF	IA.3217__	3.2	17
IA.4717SF	IA.4717__	4.7	17
IA.5717SF	IA.5717__	5.7	17
IA.6717SF	IA.6717__	6.7	17
IA.8717SF	IA.8717__	8.7	17
IA.1007SF	IA.1007__	10.7	17



Mold sets
& Die sets



Side Locks
Top Locks



Air Poppets
Air Ejectors



Spacers
Tapered Locks



Slide Latches



Gib Assemblies



Slide
Retainers



Location Rings



Date Stamps



Support Pillars
Stop Pins



Tapered
Bar Locks



Sprue Bushings
Guide Bushings



Latch Locks



Friction Pullers



MUD Pins



Flexy - Cores
Unilifters



Cycle Counters



Thin Switches



Sensor Switches



Cartridge &
Band Heaters



Hot Runners
Hot Sprue Bushings



Thermocouples



8, 12 Zones
Mold Cables



Multiple zones
Mold Power Connectors



2 Zone Connectors



Pre Wired Boxes



Nozzle Tips

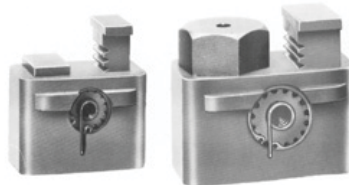

Accelerated Ejectors



Cito Manifolds



Gas Springs
Gas Cylinder



Wear Plates



Graphite Plate
Graphite Round



Brass & Nylon
Brushes



Scraping Tools



Brass Pliers



Hammers



Refacing Tools



Sprue Reamers



Chain & Nylon
Slings



Eye Bolts
Hoist Rings



Mold Clamp



Shoulder Screws
Pressure Washers



Punch Blanks



Measuring Tools



Special Pins



O Rings &
Seals



Urethane Springs

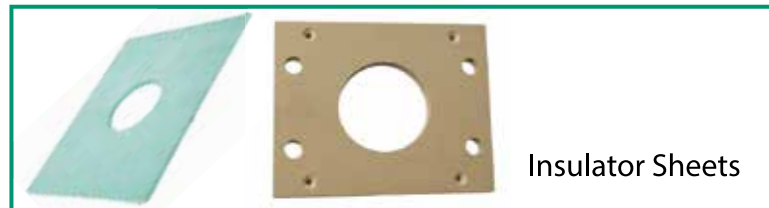

Insulator Sheets



POLISHING STONES

- BORIDE STONES
- AM-8 EDM
- AS-9 EDM
- AM-2 General Purpose
- AM-K White Al-Oxide
- AS-H White Al-Oxide
- CS Silicon Carbide Blk.
- CS-M Silicon Carbide
- CS-H Silicon Carbide
- Orange Stones
- Ruby Stones
- Special Stones



DIAMOND COMPOUNDS

- Ivory 1VH Grade
- Yellow 3VH Grade
- Orange 6VH Grade
- Green 9VH Grade
- Blue 15VH Grade
- Red 30VH Grade
- Brown 45VH Grade
- Purple 60VH Grade
- Simichrome Polish



MOUNTED POINTS

- Cylindrical
- Ball Shape
- Egg Shape
- Ball Nose
- Pointed Cone
- Blue stones
- Red stones
- White Stones



FELT BOBS

- Ball
- Cilinder
- Cone
- Softs
- Medium
- Hard

BRUSHES

- Wheel
- Cup Brass
- End Bristle
- Cotton
- Stainless



DIAMOND FILES

- Round Handle
- Flat Handle
- Miniature Sets
- Rifflers Set



SUPERSTONES

- Red 1000 Grit
- White 800 Grit
- Blue 400 grit
- Black 220 Grit
- Orange 180 Grit
- Brown 150 Grit



- Ceramic Knives
- Pen Holders
- Regular Holders

GRANDE BLH 600 MICROMOTOR GRINDER



CONTROL UNIT:

- Weigh - 5.3 LBS
- Dimensions - 9.8" x 3.5" x 7.17"
- 110 V - 120 V



AIR GRINDERS:

- Straight pencil type. 1/8" and .33mm
- 120° angle air grinder with 1/8" collet
- 120° Angle air grinders
- 90° Angle Air grinders

TURBO LAPS



- TLL 03 (Stroke 0.3 mm)
- TLL 07 (Stroke 0.7 mm)
- TLS 12 (Stroke 1.2 mm)

U - LAPS



- U-LAP 30 (0.3mm stroke)
- U-LAP 70 (0.7mm stroke)
- U-LAP 120 (1.2 mm stroke)
- U-LAP 300 (3 mm stroke)

OPTIVISOR



Optivisor Light kit

A Precision binocular headband magnifier, which permits unrestricted user efficiency while reducing eye strain

- Leaves both hands free & allows three dimensional vision.
- Can be worn over prescription or safety eyeglasses.

ACCESSORIES



- Rib Light
- Rib Light Reach



U-LAPS require the use of a 3 in 1 filter lubricator regulator. MFRL2-G



Baffles



Extension Pipes



Nipples



Hi Flow Pipes



Extension Elbows



Ex Keys Cascade



Compact Cascades



Standard Cascades



Bubblerbase



Extension Hose Barbs



Push Lock Hose



Ex Key Elbows



Quick Jumpers



Swivel Water Jumpers



Quick Plugs



Quick Hose Barbs



Female Hose Barbs



Male Hose Barbs



Hose Splitters



Water Blocker



Thread Less Plugs



Plugs



Hex Nipples



Hex Couples



Reductions



Tees



45o Elbow



90o elbows



Tee Reduction



Elbows



Thread Gauge



Hose Clamps



Teflon

Quick Extension Pipes



M Brass & Stainless

Series 200 1/4" Pipe Hole Size	NPT	Length								
	Thread Size	Catalog No.	2-1/2"	4"	5-1/2"	7"	8-1/2"	10"	11-1/2"	13"
	1/16"	P250	x025	x040	x055	-	-	-	-	-
	1/8"	P251	x025	x040	x055	x070	x085	x100	x115	x113
	1/4"	P252	x025	x040	x055	x070	x085	x100	x115	x113
	3/8"	P253	x025	x040	x055	x070	x085	x100	x115	x113

Series 300 3/8" Pipe Hole Size	NPT	Length								
	Thread Size	Catalog No.	2-1/2"	4"	5-1/2"	7"	8-1/2"	10"	11-1/2"	13"
	1/16"	P350	x025	x040	x055	-	-	-	-	-
	1/8"	P351	x025	x040	x055	x070	x085	x100	x115	x113
	1/4"	P352	x025	x040	x055	x070	x085	x100	x115	x113
	3/8"	P353	x025	x040	x055	x070	x085	x100	x115	x113
	1/2"	P354	x025	x040	x055	x070	x085	x100	x115	x113

Series 500 1/2" Pipe Hole Size	NPT	Length								
	Thread Size	Catalog No.	2-1/2"	4"	5-1/2"	7"	8-1/2"	10"	11-1/2"	13"
	3/8"	P553	x025	x040	x055	x070	x085	x100	x115	x113
	1/2"	P554	x025	x040	x055	x070	x085	x100	x115	x113

Connector Plugs



Series 200 1/4" Pipe Hole Size	NPT	Male	Female	Male Valve
	Thread Size	Catalog No.	Catalog No.	Catalog No.
	1/16"	OP-250	OP-250F	-
	1/8"	OP-251	OP-251F	-
	1/4"	OP-252	OP-252F	OP-252SV
	3/8"	OP-253	OP-253F	OP-253

Series 300 3/8" Pipe Hole Size	NPT	Male	Female	Male
	Thread Size	Catalog No.	Catalog No.	Catalog No.
	1/16"	OP-350	OP-350F	OP-350SV
	1/8"	OP-351	OP-351F	OP-351SV
	1/4"	OP-352	OP-352F	OP-352SV
	3/8"	OP-353	OP-353F	OP-353SV
	1/2"	OP-354	OP-354F	OP-354SV

Series 500 1/2" Pipe Hole Size	NPT	Male	Female	Male Valve
	Thread Size	Catalog No.	Catalog No.	Catalog No.
	1/16"	-	-	-
	1/4"	OP-552	OP-552F	OP-552SV
	3/8"	OP-553	OP-553F	OP-553SV
	1/2"	OP-554	OP-554F	OP-554SV
	3/4"	OP-556	OP-556F	OP-556SV

Quick Sockets



Socket Body Only	Series 200		Series 300		Series 500	
	Catalog No.	NPT Thread	Catalog No.	NPT Thread	Catalog No.	NPT Thread
	CMB-200-18	1/8"	CMB-300-14	1/4"	-	-
CMB-200-14	1/4"	CMB-300-38	3/8"	CMB-500-12	1/2"	

Socket STRAIGHT	Series 200		Series 300		Series 500		Valved Add SVA
	Catalog No.	Hose I.D.	Catalog No.	Hose I.D.	Catalog No.	Hose I.D.	
	OC-204A	1/4"	OC-306A	3/8"	OC-504A	1/2"	
OC-205A	5/16"	OC-308A	1/2"	OC-506A	3/4"	SVA	
OC-206A	3/8"	-	-	-	-	SVA	

Socket 90 DEGREES	Series 200		Series 300		Series 500		Valved Add SVA
	Catalog No.	Hose I.D.	Catalog No.	Hose I.D.	Catalog No.	Hose I.D.	
	OC-214A	1/4"	OC-316A	3/8"	OC-514A	1/2"	
OC-215A	5/16"	OC-318A	1/2"	OC-516A	3/4"	SVA	
OC-216A	3/8"	-	-	-	-	SVA	

Socket 45 DEGREES	Series 200		Series 300		Series 500		Valved Add SVA
	Catalog No.	Hose I.D.	Catalog No.	Hose I.D.	Catalog No.	Hose I.D.	
	OC-224A	1/4"	OC-326A	3/8"	OC-524A	1/2"	
OC-225A	5/16"	OC-328A	1/2"	OC-526A	3/4"	SVA	
OC-226A	3/8"	-	-	-	-	SVA	

Mantenimiento de Moldes

Taller / Tornería

Use aceite de corte, (Cutting Oil) fluidos de corte y lubricantes de hacer rosca para hacer modificaciones y reparación de moldes.



Limpiador de Moldes

El limpiador de moldes (Mold Cleaner) remueve los depósitos de resinas. Toallas impregnadas con limpiador de moldes se colocan en todas y cada una de las estaciones para su conveniente y rápido uso.

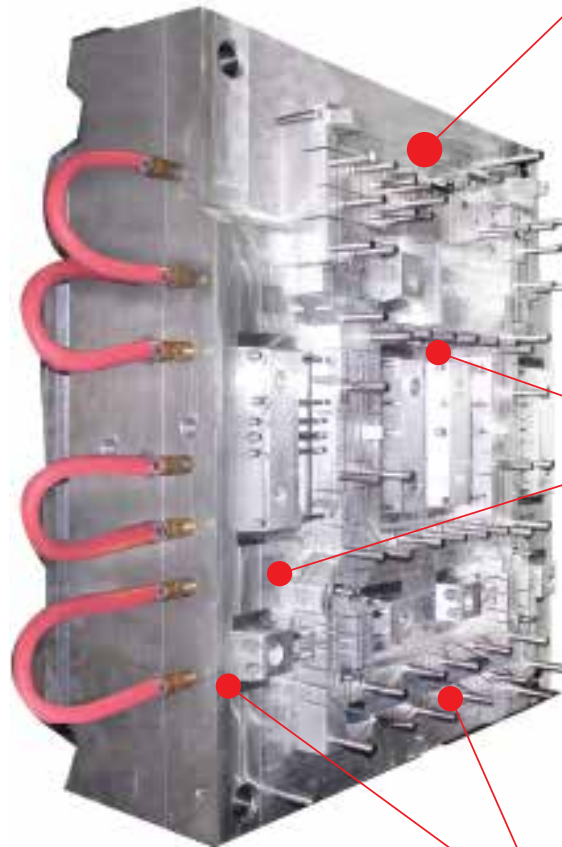
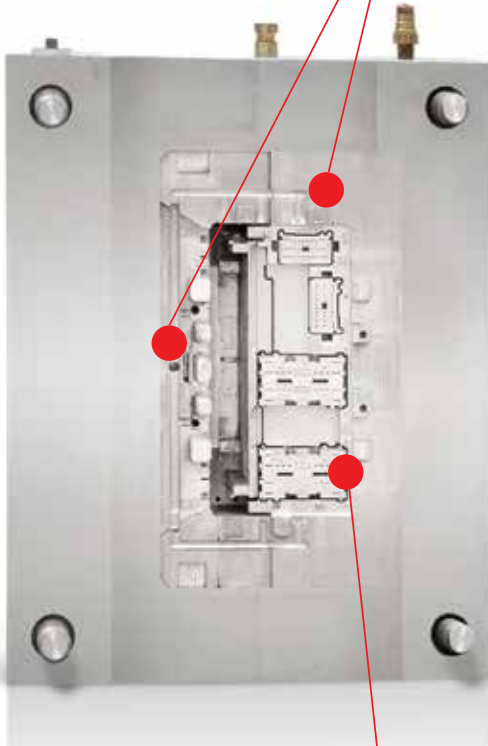

Lubricantes

Docenas de agujas de expulsión requieren periódica lubricación. Seleccione un lubricante que no marque las partes plásticas inyectadas.



Anti Oxidantes

Aplice antioxidantes de corto tiempo a los componentes críticos y a las superficies de los moldes cuando los moldes estén fuera de servicio en la noche. Preventivos especiales anti-óxido, se disiparán solos tan pronto los moldes sean puestos a trabajar y no requieren un limpiador para removerlos.



Desmoldantes

Desmoldantes se aplican en aerosol sobre el molde completo o solo en lugares donde la pieza plástica inyectada se tiende a pegar o queda



MOLD CLEANERS:



Mold Cleaner Plus Degreaser 4 No. 46910

No chlorinated solvents. Removes silicones, grease, oil and wax build-up o mold surfaces without need for wiping.

On / Cycle Mold Cleaner No. 44212

At the press warm mold cleaner. Use for multi-purpose cleaning as well as equipment cleaning.

NexGen Cleaner No. 46410

Powerful, biodegradable cleaner Meets or exceeds the toughest health and safety issues, CLEANING POWER.

Resin Remover Mold Cleaner No. 41914

Powerful solvents to remove resin build-up and most color deposits of many resinous plastics.

Citra Cling Mold & Metal Cleaner No. 46515

Foaming cleaner is a superior clinging action allows for maximum cleaning. Water-based cleaner

Plastic Cleaner with FOAM action No. 41515

Foaming spray to effectively remove oil and dirt marks from all plastics, even sensitive polycarbonates.

Mold & Metal Wipes No. 46370

Fast, convenient, cleaning towels quickly clean almost any surface*. Use for preparing molds for production.

Polish Cleaner Mold Cleaner No. 43310

Polish cleaner removes stains and mold deposits. Conditions mold for faster startups and improved releasing.



RUST PREVENTIVES



Mold Shield Dry Rust Preventive No. 42910

New ultra-dry formula delivers which will not penetrate into moving parts. Non-silicone and non-wax formulation.

White Rhino Rust Preventive No. 467

Formulated to protect plastic molding dies while in storage from corrosive attack by hydrochloric and hydrobromic acids.

NO-Rust Preventive & Inhibitor No. 40212

The one-step rust preventive that contains both neutralizer and rust preventive. Ideal for plastic mold protection.

Quick Rust Preventive with Dye No. 42810R

Dry formula makes oils stay where they are sprayed RED tracking color Fast clean up. Two years protection.

LUBRICANTS



Silicon Spray Lube No. 42112N

Silicone lubricant. An all-around general purpose lubricant for use on all kinds of machinery.

Heavy-Duty Release & Pin Lube No. 54912

An ideal lubricant for the front half of ejector pins, lubricant minimizes the possibility of leaching out onto molded parts.

Penetrant Plus Lubricant No. 41812

Non-silicone PTFE-base formulation penetrates and frees frozen parts. Lifts and replaces moisture with protective film.

Super Grease Lubricant non-aerosol No. 43900

Lubricant grease with operating temperatures from -45F to +650F. Clear, clean, non-yellowing grease. Excellent dielectric.

MOLD RELEASES



EconoMIST Silicon Mold Release No. 41612N

A light-duty mold release. NSF M1 designated Food Grade Lubricant. Is non-staining and odorless. Recognized by UL.

Quick Lecithin Mold Release No. 44812E

A medium-duty, non-silicone, paintable, all-temperature lecithin mold release agent that's fast-drying on cold and hot molds.

Polycarbonate Mold Release No. 41412

A heavy-duty, paintable mold release agent. Biodegradable & odorless. No crazing or blemishing. Recognized by UL.

Quick Paintable Mold release No. 44712E

A medium-duty, all-temperature paintable mold release agent that's fast-drying on cold and hot molds.

Silicone Mold Release Agent No. 40112N

A heavy-duty, agent that provides faster molding & more production. Approved for food machinery(++). Heat-stable.

Pure EZE Mold Release Agent No. 45712N

A non-silicone, paintable, all-purpose mold release agent. Neutral white-oil-based release contains no lecithin.

Universal Mold release No. 42612H

A heavy-duty, non-silicone, paintable mold release. FDA approved lubricant. Colorless.

Zinc Stearate Mold Release No. 41012N

A non-silicone, paintable mold release agent. Lubricant powder. For polysulfones and rubber molding and more.

Thermoset Mold Release Agent No. 45414

Mold release agent made with synthetic carnauba wax. Contains no silicones or oils.

Dry Film Lube Release Agent No. 41112N

Mold release agent formulated for deep draw molds. More durable bonded formulation.

Paintable Light Duty Mold Release No. 40012N

A light-duty, paintable mold release agent permits post-production part decoration. Paint over it. Plate over it.

Hi-Temp 1800 Mold Release No. 44110

Contains boron nitride for molding at temperatures up to 1800F. Excellent for die-casting metals.

PURGING



NPT Purging Compound No. 451-05

Purging compound requires no mixing or preparation time. Shortens purge cycle time. Eliminates need for multiple purging products. Removes all traces of barrel residue.

P.D.Q. Liquid Compound No. 43432

Liquid purging compound works with carrier for effective resin to resin and color to color changes. Purge quickly at a fraction of the cost of conventional purges.

Charge It! Re- fillable Can No. 43600

Refillable, rechargeable tank can be filled with liquid product and charged with compressed air.



Square Endmills

- Carbide
- HSS
- Titanium Coated
- Single & Double end
- 2 & 4 Flute
- Regular, Long & Ex-long



Ball Endmills

- Carbide
- HSS
- Titanium Coated
- Single & Double end
- 2 & 4 Flute
- Regular, Long & Ex-long



Vi-Pro Endmills

- High Performance
- Carbide Altin- Coated
- 4 & 5 Flute
- Regular, Long & Ex-long



Micro Endmills

- Carbide Ball
- Carbide Square
- Carbide Metric Ball
- Carbide metric SQ
- 1/8" Shank



Carbide Burs

- Cylindrical
- Ball Shape
- Egg Shape
- Ball Nose
- Pointed Cone



Reamers

- Carbide
- HSS Sets
- Titanium Coated
- Sprue Reamers
- 5 & 6 Flute



Drill Bits

- Carbide Drills
- M42 Cobalt
- HSS Long
- Jobber Black & Gold
- Special



Countersinks

- Carbide regular
- Carbide Combined
- HSS Combined
- Combined Long
- One to Six Flute



TAPS & Dies

- Carbide Drills
- M42 Cobalt
- HSS Long
- Jobber Black & Gold
- Special



CARBIDE | HIGH SPEED STEEL | COBALT

TITAN USA

TRUST IN TITAN USA
To Keep Your Tool Crib Stocked

Premium Quality Tools at Exceptional Value | End Mills - Drills - Reamers - Taps & Dies - Burs - Countersinks
Chamfer Mills - Thread Mills - Drill Mills - Micro End Mills

FALL 2022

Catalog

Premium Quality Cutting Tools For Precision Machining. See our Catalog 50% Discount



Drill Sets

- M42 Cobalt
- High Speed Steel
- Jobber Drill Sets
- Black Gold
- Heavy Duty

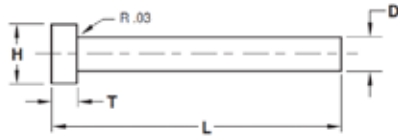

Dimension	Tolerance
D	<input type="checkbox"/> Standard Ejector Pin +
	<input type="checkbox"/> Standard Core Pin -
H	<input type="checkbox"/> Standard +
T	<input type="checkbox"/> Standard +
L	<input type="checkbox"/> Standard +
K	<input type="checkbox"/> Standard +
Quantity:	

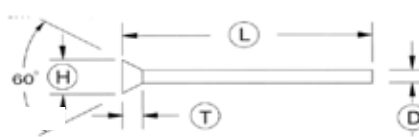

Dimension	Tolerance
D	<input type="checkbox"/> Standard Ejector Pin +
	<input type="checkbox"/> Standard Core Pin -
H	<input type="checkbox"/> Standard +
T	<input type="checkbox"/> Standard +
L	<input type="checkbox"/> Standard +
K	<input type="checkbox"/> Standard +
Quantity:	

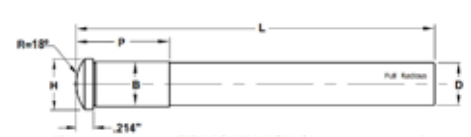

ANGLE PIN #1	
Dimension	Tolerance
D	<input type="checkbox"/> Standard +
B	<input type="checkbox"/> Standard +
H	<input type="checkbox"/> Standard +
P	<input type="checkbox"/> Standard +
L	<input type="checkbox"/> Standard +
Quantity:	

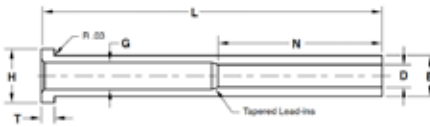

SLEEVE #1	
Dimension	Tolerance
D	<input type="checkbox"/> Standard +
B	<input type="checkbox"/> Standard +
G	<input type="checkbox"/> Standard +
L	<input type="checkbox"/> Standard +
N	<input type="checkbox"/> Standard +
H	<input type="checkbox"/> Standard +
T	<input type="checkbox"/> Standard +
Quantity:	

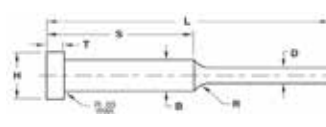

Dimension	Tolerance
D	<input type="checkbox"/> Standard Ejector Pin +
	<input type="checkbox"/> Standard Core Pin -
B	<input type="checkbox"/> Standard Ejector Pin +
L	<input type="checkbox"/> Standard +
	<input type="checkbox"/> Standard -
S	<input type="checkbox"/> Standard +
H	<input type="checkbox"/> Standard +
T	<input type="checkbox"/> Standard +
K	<input type="checkbox"/> Standard +
R	<input type="checkbox"/> Standard +
Quantity:	

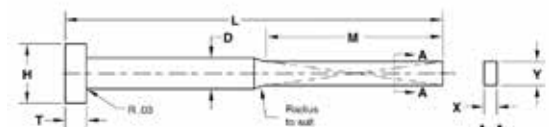

BLADE #1	
Dimension	Tolerance
X	<input type="checkbox"/> Standard +
Y	<input type="checkbox"/> Standard +
D	<input type="checkbox"/> Standard +
L	<input type="checkbox"/> Standard +
M	<input type="checkbox"/> Standard +
H	<input type="checkbox"/> Standard +
T	<input type="checkbox"/> Standard +
Quantity:	

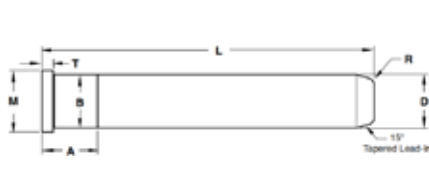

Dimension	Tolerance
D	<input type="checkbox"/> Standard +
L	<input type="checkbox"/> Standard +
A	<input type="checkbox"/> Standard +
B	<input type="checkbox"/> Standard +
M	<input type="checkbox"/> Standard +
T	<input type="checkbox"/> Standard +
R	<input type="checkbox"/> 1/8 for D= 1.14 max.
	<input type="checkbox"/> 3/16 for D over 1.14
Quantity:	

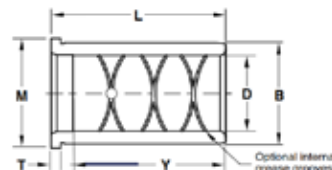

BUSHING #1	
Dimension	Tolerance
D	<input type="checkbox"/> Standard +
B	<input type="checkbox"/> Standard +
L	<input type="checkbox"/> Standard +
M	<input type="checkbox"/> Standard +
T	<input type="checkbox"/> Standard +
Y	<input type="checkbox"/> Standard +
Grease Grooves	<input type="checkbox"/> Yes <input checked="" type="checkbox"/> No
Quantity:	

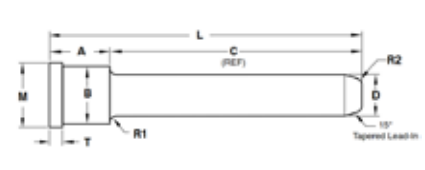

Dimension	Tolerance
D	<input type="checkbox"/> Standard +
B	<input type="checkbox"/> Standard +
L	<input type="checkbox"/> Standard +
A	<input type="checkbox"/> Standard +
C	REF
M	<input type="checkbox"/> Standard +
T	<input type="checkbox"/> Standard +
R1	
R2	
Quantity:	

EL PASO
MOLD SUPPLY

Proud distributor of these
quality products.



More than 25 years serving the Juarez / El Paso Plastic Injection Industry.

More than 15,000 components and supplies for fast local deliveries.

Proud distributor of our manufactures quality products



El Paso, Texas, United States

11500 Pellicano Dr. STE C-7
El Paso, TX 79936
United States

Ph. (915) 591-1296
E-Mail. Epmold@aol.com



Ciudad Juarez, Chihuahua, Mexico

Av. Paseo Triunfo de la Republica 5298
Col. San Lorenzo 32320
Ciudad Juarez, Chihuahua, Mexico.

Ph. (656) 823-5507
E-Mail. jmoldsupply@gmail.com



Juriquilla, Queretaro, Mexico

Real de Morelos Lt 9, Mza 11
Camino Real, Rancho Largo 76220.
Santa Rosa Jauregui, Querétaro, Mexico

Ph. (442) 241-3411
E-Mail. Moldsupplybajo@gmail.com